

## Introduction

DPP Planning is preparing to submit a Full Planning Application for improvement works at East Durham College - Houghall Campus, Houghall, Durham, DH1 3SG.

The application is being submitted by Tilbury Douglas on behalf of the Department for Education. We would like to provide you with an opportunity to view and comment on the proposals ahead of formal submission to Durham County Council.

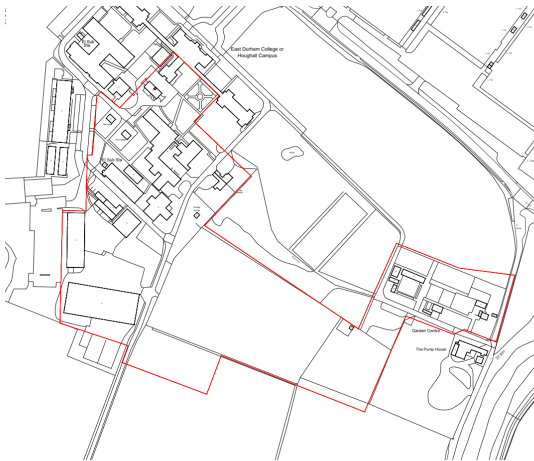

Site Location Plan

## The Site

The Site extends to approximately 6.5 hectares and is located approximately 1.3 miles southwest of Durham City Centre, within the Durham South Ward. The Site is currently in educational use for the East Durham College – Houghall Campus, with teaching facilities and agricultural buildings. Further details on the existing context can be found on the dedicated website.

## Have your say

We would welcome any feedback you may have on the proposals.

We invite you to view the proposal, speak to the project team and provide any comments you may have at our consultation event, which will be held on **Wednesday 15th May 2024 at East Durham and Houghall Community College, Houghall, Durham, DH1 3SG** from **4:15pm to 7pm**.

We also invite you to visit our webpage at <https://dpp1.co.uk/houghall/> to view the proposals and submit any feedback.

Alternatively, comments can be emailed to **consultation@dppukltd.com** or posted to **DPP, Studio 015 Haylofts, St Thomas Street, Newcastle Upon Tyne, NE1 4LE**.

Please submit any comments by **Wednesday 22nd May 2024**.

### Proposed Development

The proposal comprises the partial demolition of the existing college buildings, partial refurbishment and repurposing of existing buildings and construction of a new two-storey teaching block and agricultural buildings (Hay Barn and Sheep Shed, Grain Store and Boot Wash) with associated external areas, landscaping and accesses. Alongside the new-build elements, the proposal includes a Learning Resource Centre refurbishment and further cattle pens to the existing Animal Shed. These new and refurbished elements will serve as an extension to the existing facilities to future-proof the campus in line with the college's strategic operational requirements.

External spaces associated with the new building include service areas (for deliveries and refuse collection), the main entrance area (including a terrace for outdoor dining), SEN garden, car park and circulation spaces.

It is also proposed that additional landscaping will be provided throughout the Site, including tree and hedgerow planting.

The Proposed Whole Site Plan and an image of the proposed Teaching Block are provided to the right, and further details can be found on the dedicated website (see link below).

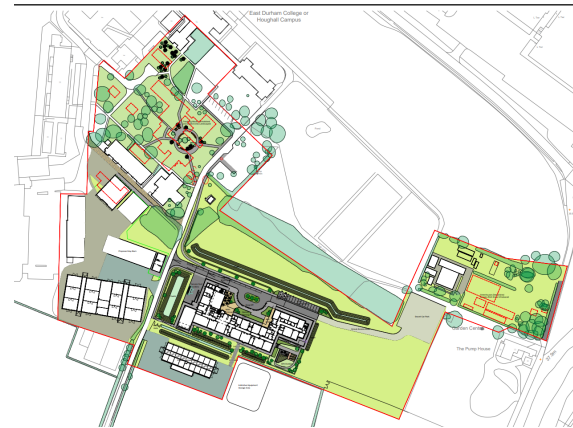

Proposed Whole Site Plan (Indicative for public consultation purposes)



CGI of Teaching Block (Indicative for public consultation purposes)